

Assembly Instructions

MODEL NO:ML-2 WRML-305/2

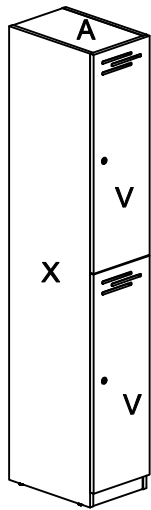

Pin 6×35 23PCS	Hinge (full-overlay) 4PCS	Lock 2PCS	Wood Screw 4×20 8PCS	 ø6×40 2PCS
Cam 23PCS	Wood Screw 4×16 34PCS	Lock Catcher 2PCS	Cloth Rail 269W 2PCS	Wood Screw 4×40 2PCS
Cam Cover 23PCS	ADJ. Feet ø18×5H 4PCS	Wood Screw 3.5×13 4PCS	 73×23×15 2PCS	

STEP1

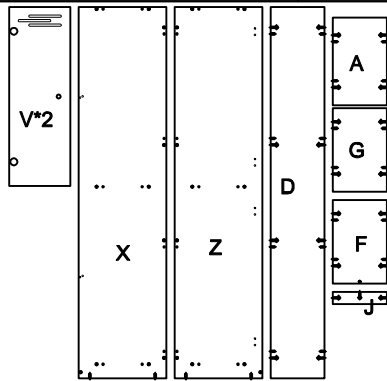

STEP2

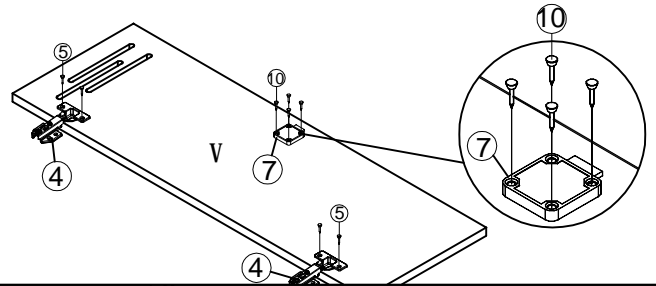

STEP3

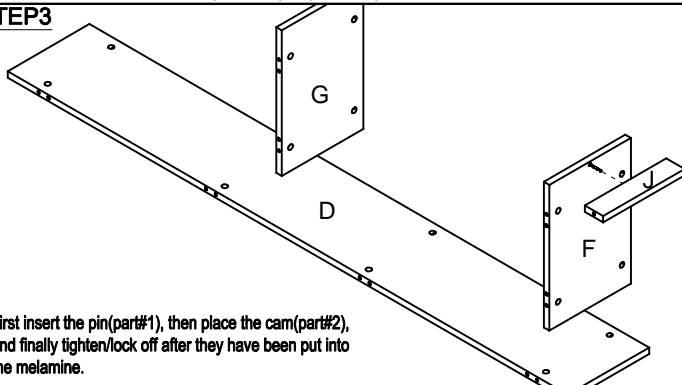

First insert the pin(part#1), then place the cam(part#2), and finally tighten/lock off after they have been put into the melamine.

STEP4

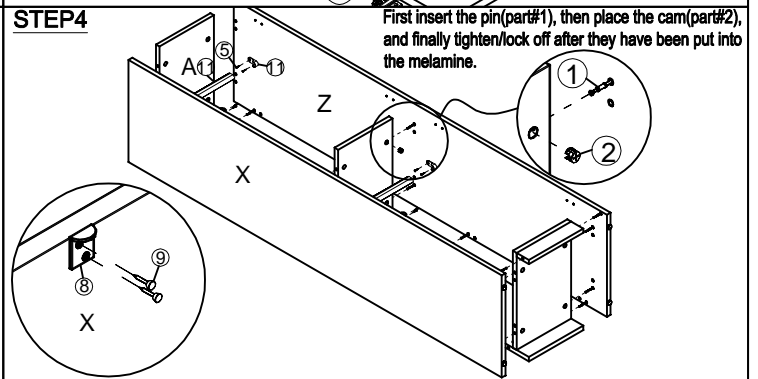

First insert the pin(part#1), then place the cam(part#2), and finally tighten/lock off after they have been put into the melamine.

STEP5

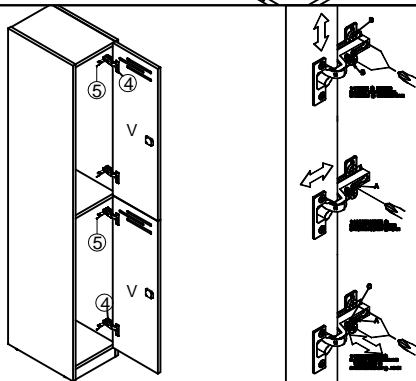

STEP6

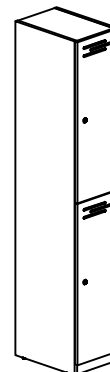

IMPORTANT NOTE:

- Place all laminated parts on a clean and smooth surface such as a rug or carpet to avoid the parts from being scratched.
- Check to be sure that you have all parts and hardware.
- Remove all wrapping materials, including staples & packing straps before you start to assemble.
- Don't tighten all screws/bolts until all completely assembled.
- Keep all hardware parts out of reach of children

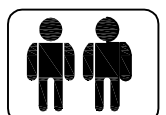

Assembly Instructions

MODEL NO: ML-2 WRML-305/2

The warning sticker provided within this hardware kit **MUST** be attached to the piece furniture in a place that is 100% visible when the item is empty.

STEP5

Make a mark with a pencil

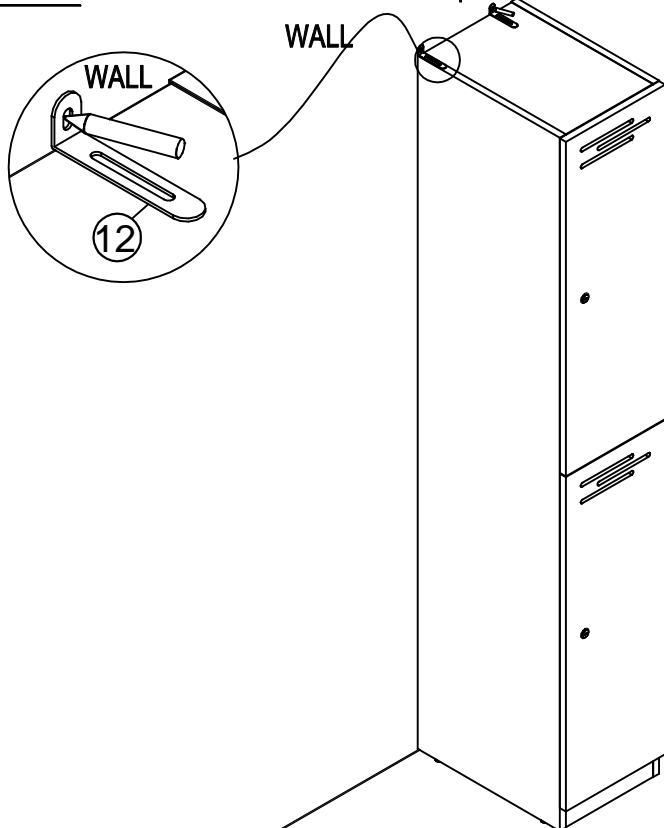

STEP6

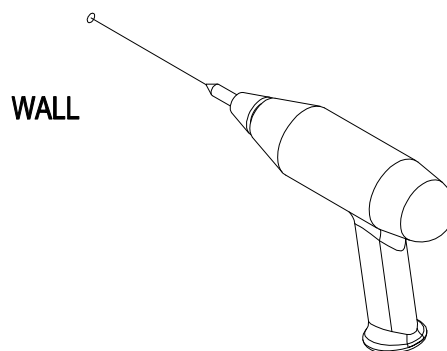

Drill holes at the marks with an electric drill

STEP7

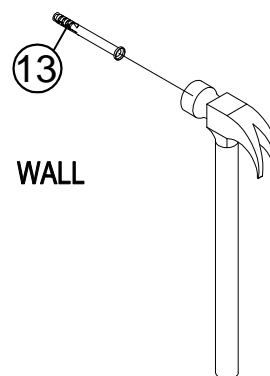

STEP8

WALL

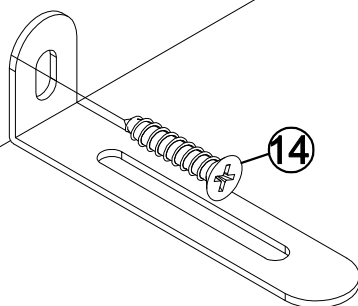

STEP9

WALL

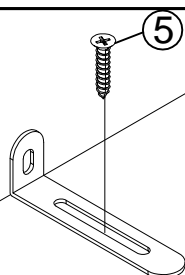

⚠ WARNING



Children have died from furniture tipover.

- ALWAYS secure it with an anchor device.
- NEVER allow children to stand, climb or hang on drawers, doors, or shelves.
- NEVER open more than one drawer at a time.
- Place heavy items down low.

NEVER put a TV on this furniture



This furniture type is at high risk of toppling over

Ask staff for more information or visit <https://www.productsafety.gov.au>

IMPORTANT NOTE:

- Place all laminated parts on a clean and smooth surface such as a rug or carpet to avoid the parts from being scratched.
- Check to be sure that you have all parts and hardware.
- Remove all wrapping materials, including staples & packing straps before you start to assemble.
- Don't tighten all screws/bolts until all completely assembled.
- Keep all hardware parts out of reach of children

