

# Assembly Instructions

MODEL NO:CH18N SPH18 IFH18

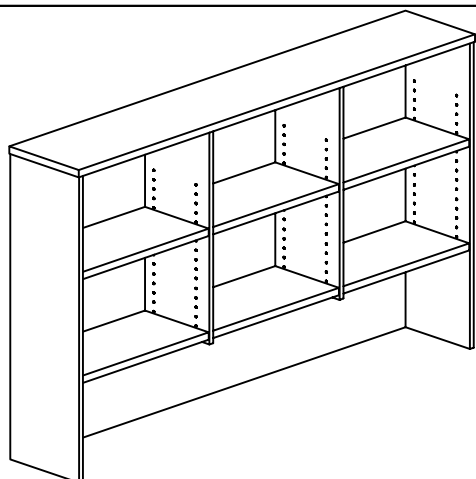

<b>Pin</b>  <b>6x35</b> <b>22PCS</b>	<b>Cam</b>  <b>22PCS</b>	<b>Cam Cover</b>  <b>22PCS</b>
<b>Shelf Pin</b>  <b>24PCS</b>	<b>Bracket</b>  <b>4PCS</b>	<b>Wood Screw 4x16</b>  <b>18PCS</b>
 <b>73x23x15</b> <b>2PCS</b>	 <b>ø6x40</b> <b>2PCS</b>	<b>Wood Screw 4x40</b>  <b>2PCS</b>

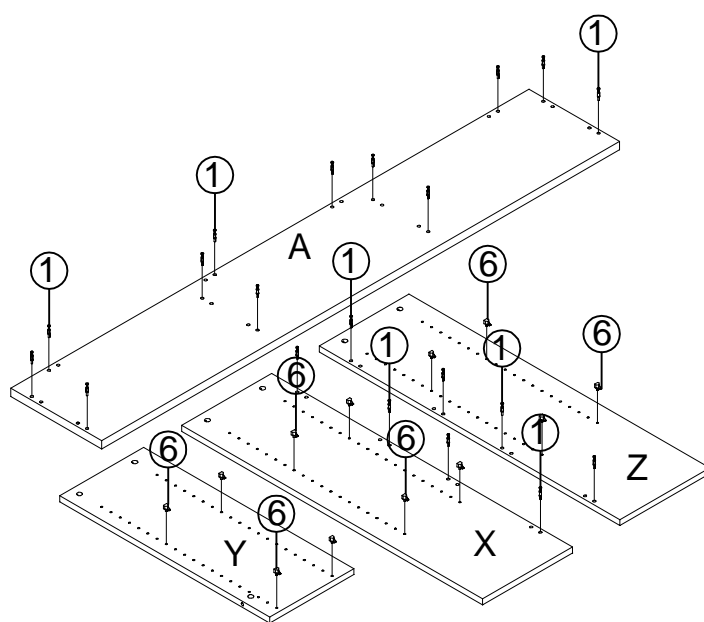
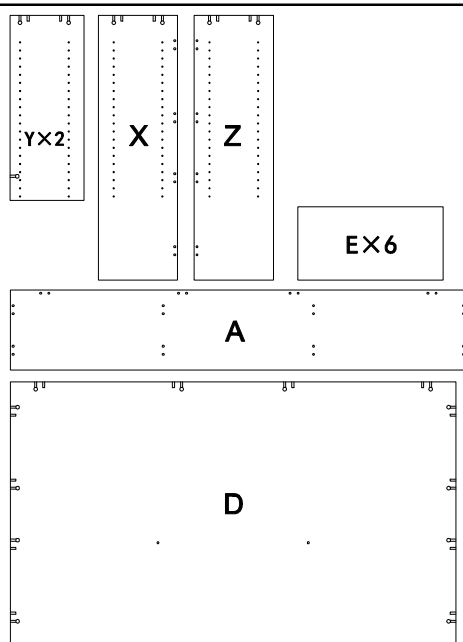

## STEP1

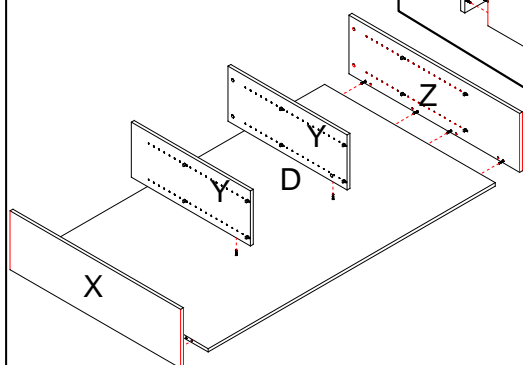

## STEP2

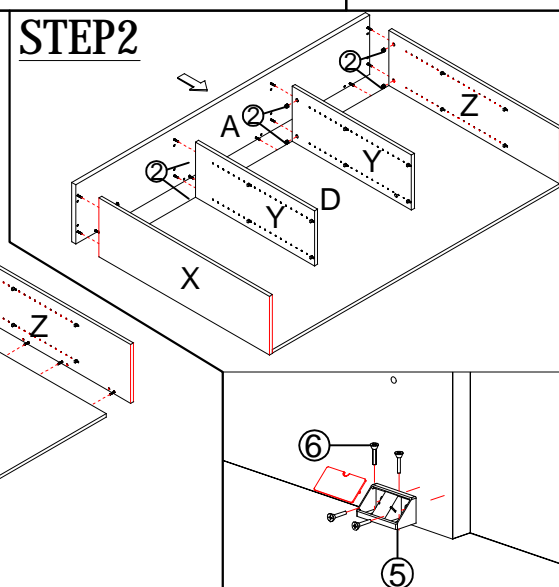

## STEP3

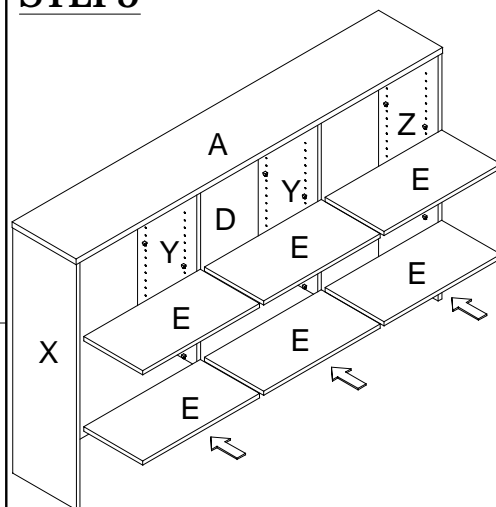

### IMPORTANT NOTE:

- Place all laminated parts on a clean and smooth surface such as a rug or carpet to avoid the parts from being scratched.
- Check to be sure that you have all parts and hardware.
- Remove all wrapping materials, including staples & packing straps before you start to assemble.
- Don't tighten all screws/bolts until all completely assembled.
- Keep all hardware parts out of reach of children

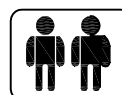

# Assembly Instructions

MODEL NO:CH18N SPH18 IFH18

The warning sticker provided within this hardware kit **MUST** be attached to the piece furniture in a place that is 100% visible when the item is empty.

## STEP4

Make a mark with a pencil

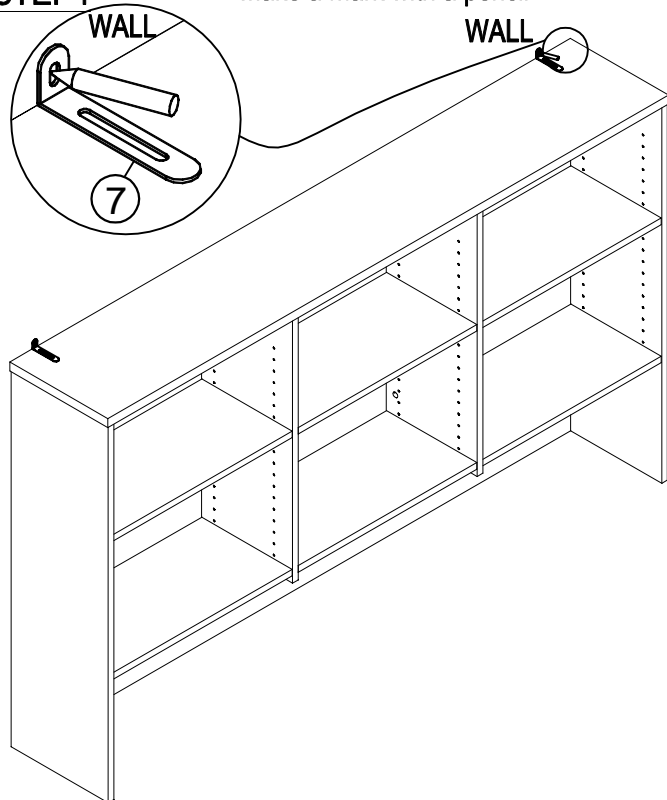

## STEP5

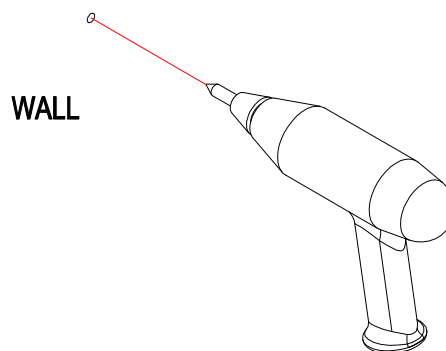

Drill holes at the marks with an electric drill

## STEP6

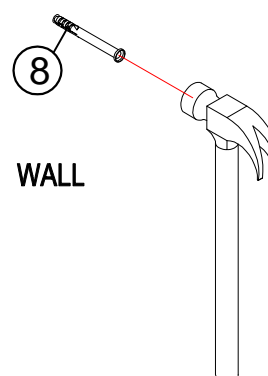

## STEP7

WALL

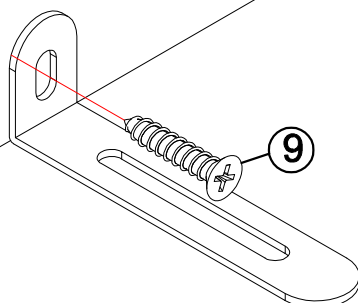

## STEP8

WALL

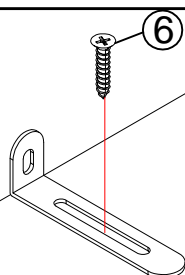

## ⚠ WARNING



**NEVER** put a TV  
on this Furniture



**This furniture type is at high risk of toppling over.**

**Children have died from furniture tipover.**

- ALWAYS secure it with an anchor device.
- NEVER allow children to stand, climb or hang on drawers, doors or shelves.
- NEVER open more than one drawer at a time
- PLACE heavy items down low.

Ask staff for more information or visit  
<http://www.productsafety.gov.au>

This is a permanent label. Do not remove!

### IMPORTANT NOTE:

- Place all laminated parts on a clean and smooth surface such as a rug or carpet to avoid the parts from being scratched.
- Check to be sure that you have all parts and hardware.
- Remove all wrapping materials, including staples & packing straps before you start to assemble.
- Don't tighten all screws/bolts until all completely assembled.
- Keep all hardware parts out of reach of children

