

Assembly Instructions

MODEL NO:CSC2HD

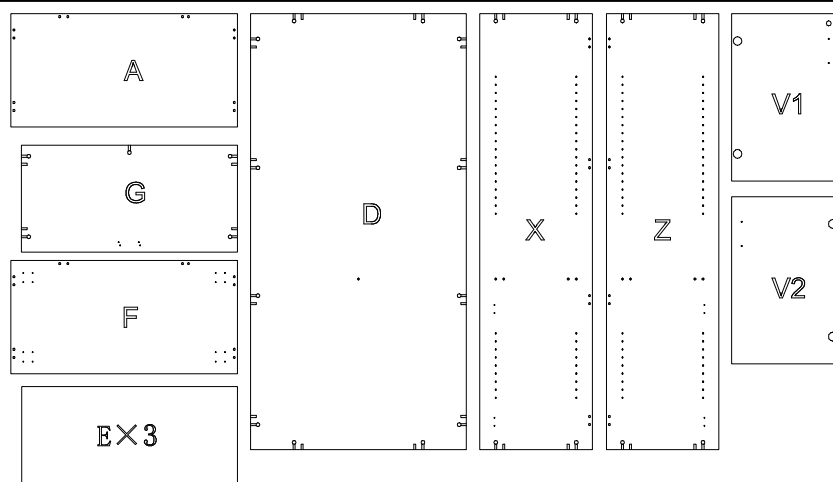
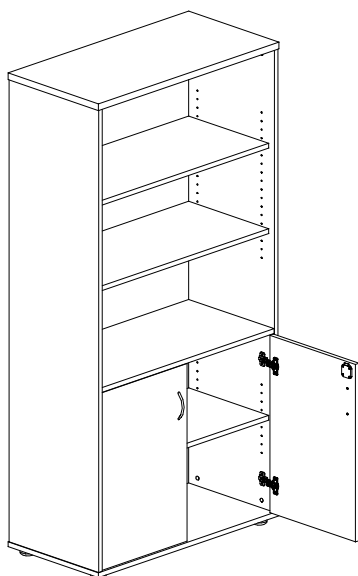

| | |
|----------------------------------|-------------------------------|
| Pin 6x35 1 25PCS | Cam 2 25PCS |
| Cam Cover 3 25PCS | Shelf Pin 4 12PCS |
| Hinge(Inset) 5 4PCS | Handle AM-103-96 6 2PCS |
| Handle Screw 4x22 7 4PCS | Wood Screw 4x16 8 26PCS |
| ADJ. Feet ø42x25H 9 4PCS | Lock Catcher 10 2PCS |
| Lock 11 1PCS | Wood Screw 4x20 12 4PCS |
| Wood Screw 3.5x13 13 20PCS | 73x23x15 14 2PCS |
| ø8x40 15 2PCS | Wood Screw 4x40 16 2PCS |

STEP1

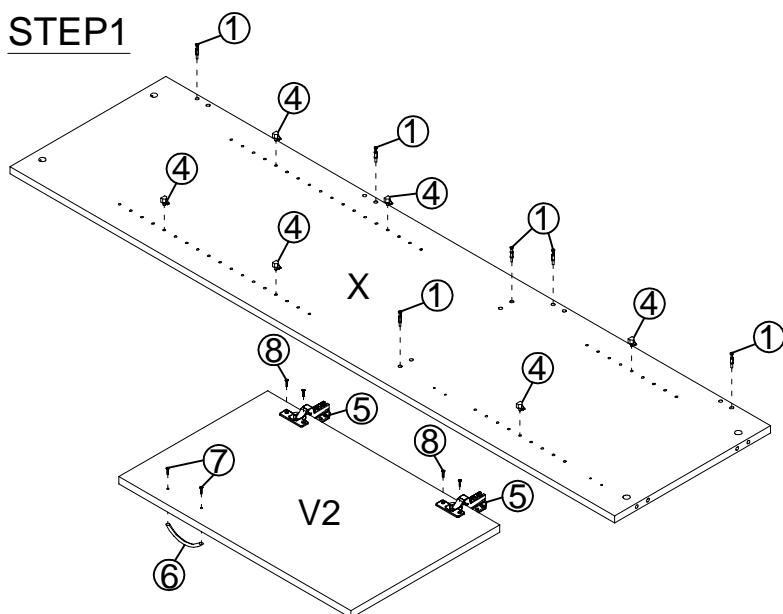

STEP2

First insert the pin(part#1), then place the cam(part#2), and finally tighten/lock off after they have been put into the melamine.

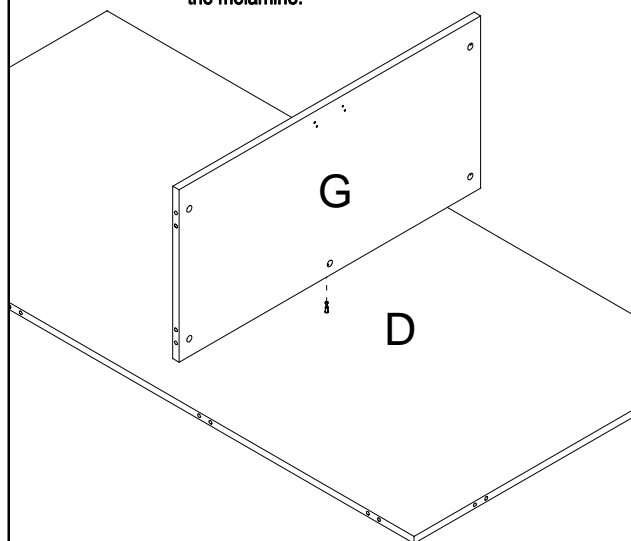

IMPORTANT NOTE:

- Place all laminated parts on a clean and smooth surface such as a rug or carpet to avoid the parts from being scratched.
- Check to be sure that you have all parts and hardware.
- Remove all wrapping materials, including staples & packing straps before you start to assemble.
- Don't tighten all screws/bolts until all completely assembled.
- Keep all hardware parts out of reach of children

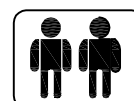

Assembly Instructions

MODEL NO:CSC2HD

STEP3

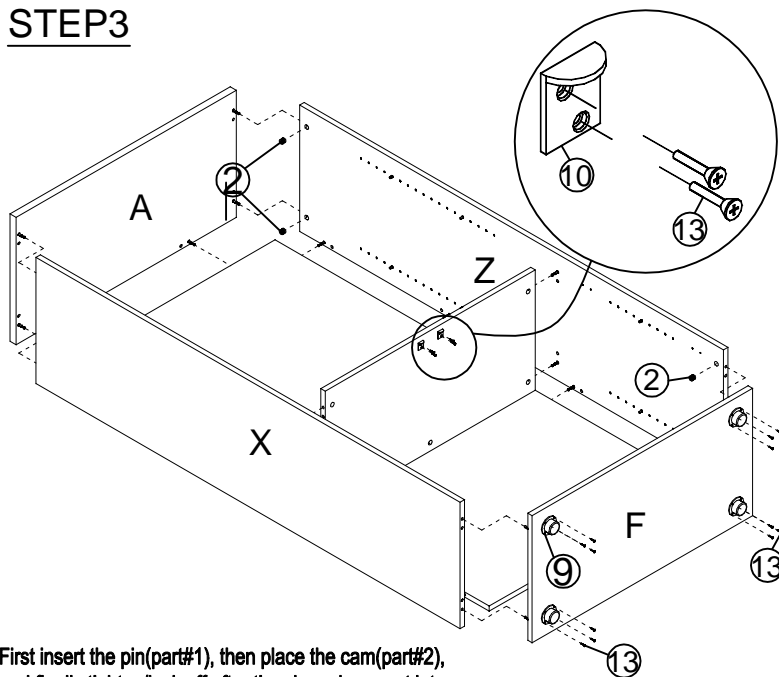

First insert the pin(part#1), then place the cam(part#2), and finally tighten/lock off after they have been put into the melamine.

STEP4

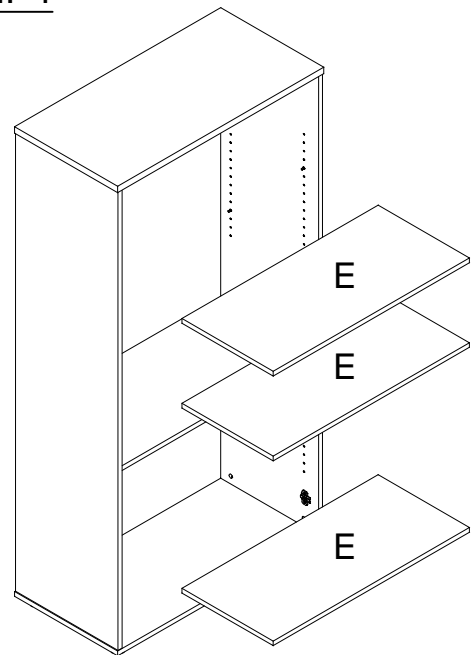

STEP5

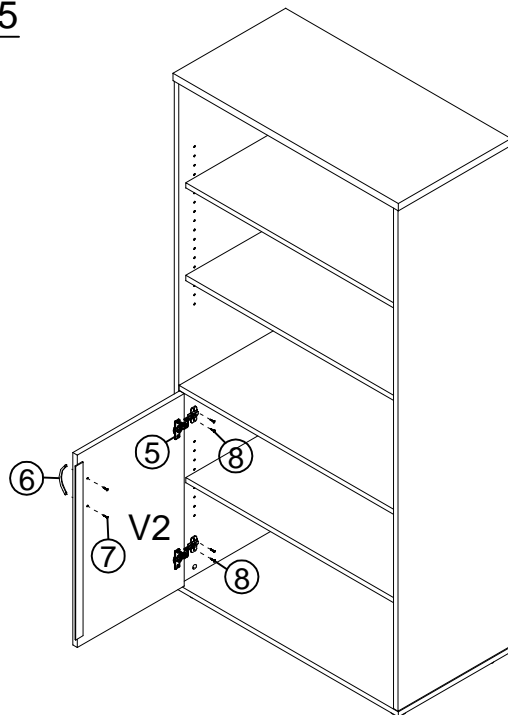

STEP6

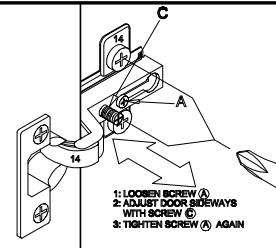
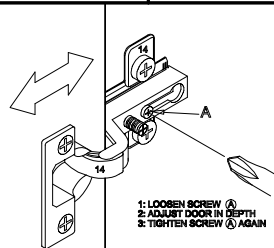
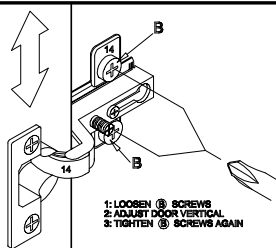
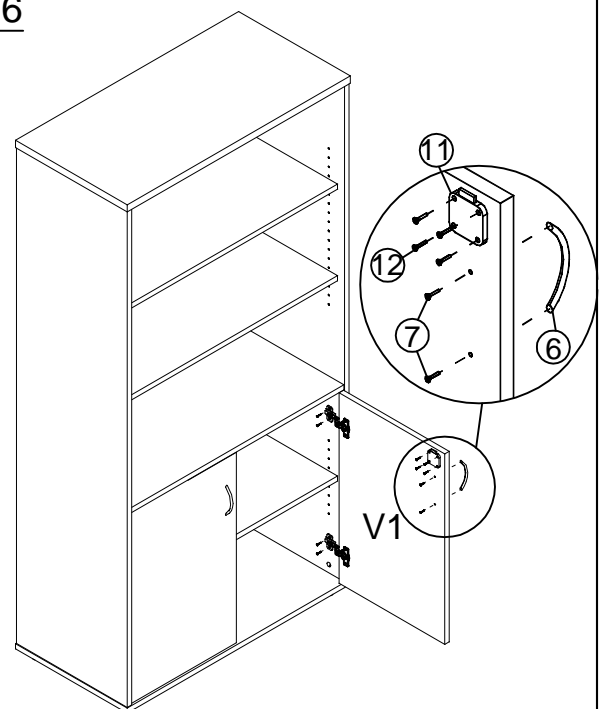

IMPORTANT NOTE:

- Place all laminated parts on a clean and smooth surface such as a rug or carpet to avoid the parts from being scratched.
- Check to be sure that you have all parts and hardware.
- Remove all wrapping materials, including staples & packing straps before you start to assemble.
- Don't tighten all screws/bolts until all completely assembled.
- Keep all hardware parts out of reach of children



Assembly Instructions

MODEL NO: CSC2HD

The warning sticker provided within this hardware kit **MUST** be attached to the piece furniture in a place that is 100% visible when the item is empty.

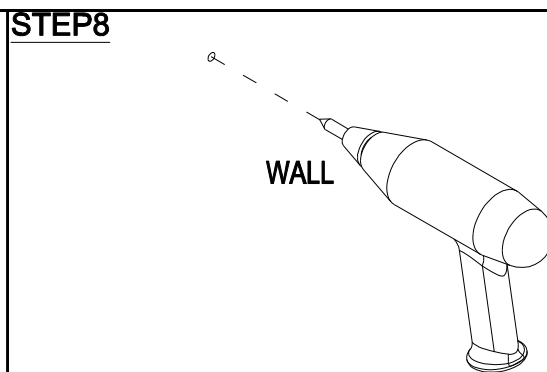
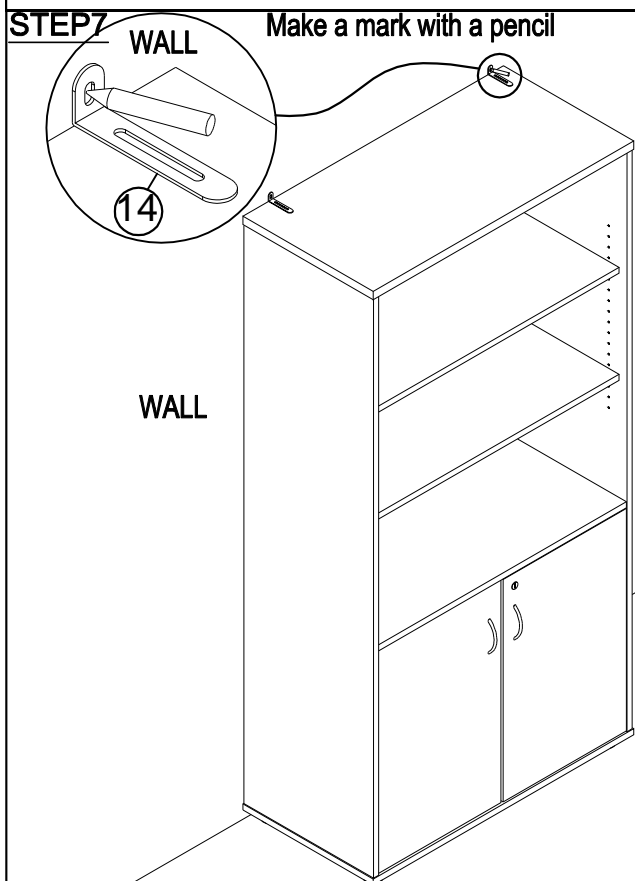

Drill holes at the marks with an electric drill

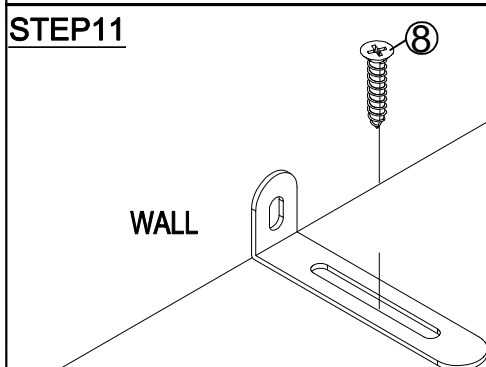
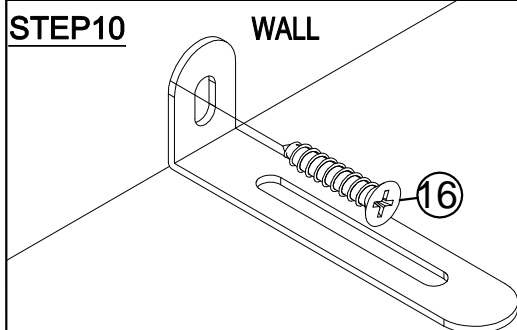
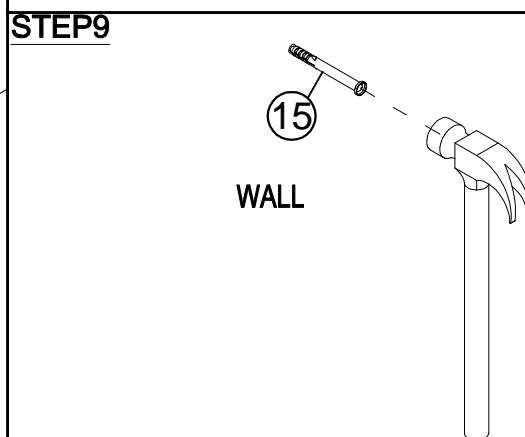

⚠ WARNING



Children have died from furniture tipover.

- ALWAYS secure it with an anchor device.
- NEVER allow children to stand, climb or hang on drawers, doors, or shelves.
- NEVER open more than one drawer at a time.
- Place heavy items down low.

NEVER put a TV on this furniture



This furniture type is at high risk of toppling over

Ask staff for more information or visit <https://www.productsafety.gov.au>

IMPORTANT NOTE:

- Place all laminated parts on a clean and smooth surface such as a rug or carpet to avoid the parts from being scratched.
- Check to be sure that you have all parts and hardware.
- Remove all wrapping materials, including staples & packing straps before you start to assemble.
- Don't tighten all screws/bolts until all completely assembled.
- Keep all hardware parts out of reach of children

